

WELER CHUCKS

Why is the Weler Chuck the Best Choice?



WHY THE WELER CHUCK?

The Weler Chuck is the most versatile chuck available in the market place today!

It is recommended for precision finishing, drilling, reaming, thread milling, and rough milling in axial and radial applications.

The Weler Chuck can accept any cylindrical shank tool with or without flats or notches and maintain the high clamping force.

Axial adjustment positioning of the tool can be made with the positive stop set screw.

The Weler Chuck is designed for the nose nut to be tightened to the positive stop.

THERE IS NO GUESSING!

Call today for a 30 day guarantee demonstration in your plant to see for yourself.



Designed for Milling & Drilling



Coolant Thru Capabilities

Rated up to the maximum capability of 1,500 Form B Available

Balanced to G2.5 20.000 RPM's

No Needle Bearings

Slim Nose Design



.0001" Runout @ 2-1/2 x Diameter

Screws to a Positive Stop No Guessing!

Over 380 FT/LB of Clamping Force

Technical Info

Weler Size	Concentricity 2.5xØ		Clamping Forces	
	mm	inch	Nm	ft/lbs
20mm	0.003	0.0001"	520	384
32mm	0.004	0.0002"	600	443
1 1/4	0.004	0.0002"	600	443

The typical bearing milling chuck has 150-200 ft/lbs of clamping force and .001 to .002 of runout. Good only for milling. The needle bearing milling chuck does not have the concentricity for drilling.

The typical hydraulic chuck has 200-300 ft/lbs of clamping force and .0001 to .0002 of runout. Good only for drilling and very light milling. Heavy radial forces will damage the hydraulic holders bladder which is costly to repair. The only product available in the market place that has better clamping force and a runout combination than the Weler Chuck is the shrink fit system. The Weler Chuck is the only system that has sufficient clamping forces for heavy milling and the concentricity for drilling operations along with the flexibility to hold multiple shank sizes.

Certified Accuracy



All Weler Chucks are **100% Inspected**, assigned a serial number and values are recorded on each Certificate.

Maintenance

To ensure the proper performance and maximum life of the Weler Chuck, grease must be applied as needed to the threads and taper that the tapered locking nut is fastened to. This will prevent the occurrence of any gaulding from the metal on metal contact. This is the only maintenance required as there are no wear parts during the normal recommended use of the Weler Chuck. One tube of grease is included with every chuck.



CAT 40 - CAT 50 Form AD (Coolant Thru the Shank)

EDP	Part Number	Taper	d	D	D1	L	L1
15021B	520000/40CAT	40	20mm	1.81	1.929	3.54	0.906
15023B	532000/40CAT	40	32mm	2.64	2.677	4.13	1.299
51001B	531700/40CAT	40	1-1/4"	2.64	2.677	4.13	1.299
15029B	520000/50CAT	50	20mm	1.81	1.929	3.54	0.906
15031B	532000/50CAT	50	32mm	2.64	2.677	4.05	1.299
15066B	531700/50CAT	50	1-1/4"	2.64	2.677	4.05	1.299

CAT 40 - CAT 50 Form B (Coolant Thru the Flange)

EDP	Part Number	Taper	d	D	D1	L	L1
51002B	520000/40CAT-B	40	20mm	1.81	1.929	3.54	0.906
51003B	532000/40CAT-B	40	32mm	2.64	2.677	4.13	1.299
51004B	520000/50CAT-B	50	20mm	1.81	1.929	3.54	0.906
51005B	532000/50CAT-B	50	32mm	2.64	2.677	4.05	1.299

MAS 403 BT

EDP	Part Number	Taper	d	D	D1	L	L1
15067B	520000/30BT	30	20mm	1.81	1.947	3.54	0.306
15037B	520000/40BT	40	20mm	2.64	1.929	3.54	0.906
15039B	532000/40BT	40	32mm	2.64	2.677	3.74	1.299
15045B	520000/50BT	50	20mm	1.81	1.929	3.94	0.306
15047B	532000/50BT	50	32mm	2.64	2.677	4.33	1.299

HSK

EDP	Part Number	Taper	d	D	D1	L	L1
15137B	520000/H40E	40E	20mm	1.81	1.929	3.66	0.906
15068B	520000/H50A	50A	20mm	1.81	1.929	3.94	0.906
15138B	520000/H50E	50E	20mm	1.81	1.929	4.00	0.906
15005B	520000/H63A	63A	20mm	1.81	1.929	3.98	0.906
15007B	532000/H63A	63A	32mm	2.64	2.677	4.45	1.299
15012B	520000/H63E	63E	20mm	1.81	1.929	3.82	0.906
15014B	532000/H63E	63E	32mm	2.64	2.677	4.45	1.299
15105B	520000/H100A	100A	20mm	1.81	1.929	4.33	1.299
15164B	532000/H100A	100A	32mm	2.64	2.677	4.33	1.299

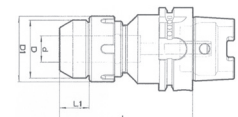
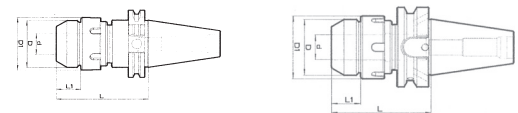

EXCELLENT *Choice* **FOR**
MILLING, INDEXABLE, DRILLING,
REAMING & THREADMILLING

WELER CHUCK

Hi-Pressure Coolant Nuts,
Wrenches & Extractors



**RATED
UP TO
1,500 PSI**

Hi-Pressure Nuts

EDP	Part Number	Size
15281A	520020L	20mm
15282A	532020L	32mm



Weler Wrenches

EDP	Part Number	Description	Size
15048A	520011	Weler Wrench	20mm
15904A	532011	Weler Wrench	32mm



Spanner Wrenches

EDP	Part Number	Description	Size
15280A	M-52-03	Adjustable Spanner Wrench for Hi-Pressure Weler Nut	20mm & 32mm



20mm All Sizes



Minimum 1/4" or 6mm

Reduction Sleeve Extractor

EDP	Part Number	Reduction Sleeve Size
15179A	520016	20mm
15178A	532016	20mm & 32mm

Weler Grease

EDP	Part Number	Description
15069A	500023	Grease

20mm Hi-Pressure Coolant Caps (inch)

EDP	Part Number	Size	ID
15243A	520012-3/16 L	20mm	3/16
15244A	520012-1/4 L	20mm	1/4
15245A	520012-5/16 L	20mm	5/16
15246A	520012-3/8 L	20mm	3/8
15247A	520012-7/16 L	20mm	7/16
15248A	520012-1/2 L	20mm	1/2
15249A	520012-5/8 L	20mm	5/8

20mm Hi-Pressure Coolant Caps (metric)

EDP	Part Number	Size	ID
15260A	520012-4 L	20mm	4
15261A	520012-5 L	20mm	5
15262A	520012-6 L	20mm	6
15263A	520012-8 L	20mm	8
15264A	520012-10 L	20mm	10
15265A	520012-12 L	20mm	12
15266A	520012-14 L	20mm	14
15267A	520012-15 L	20mm	15
15268A	520012-16 L	20mm	16
15269A	520012-18 L	20mm	18
15283A	520012-20 L	20mm	20

32mm Hi-Pressure Coolant Caps (inch)

EDP	Part Number	Size	ID
15250A	532012-1/4 L	32mm	1/4
15251A	532012-5/16 L	32mm	5/16
15252A	532012-3/8 L	32mm	3/8
15253A	532012-7/16 L	32mm	7/16
15254A	532012-1/2 L	32mm	1/2
15255A	532012-5/8 L	32mm	5/8
15256A	532012-3/4 L	32mm	3/4
15257A	532012-7/8 L	32mm	7/8
15258A	532012-1 L	32mm	1

32mm Hi-Pressure Coolant Caps (metric)

EDP	Part Number	Size	ID
15270A	532012-6 L	32mm	6
15271A	532012-8 L	32mm	8
15272A	532012-10 L	32mm	10
15273A	532012-12 L	32mm	12
15274A	532012-14 L	32mm	14
15275A	532012-16 L	32mm	16
15276A	532012-18 L	32mm	18
15277A	532012-20 L	32mm	20
15278A	532012-24 L	32mm	24
15284A	532012-32 L	32mm	32

20mm Reduction Sleeves (inch)

EDP	Part Number	D	d	L
15050A	9020.20.1/8	20mm	1/8	1.96"
15051A	9020.20.3/16	20mm	3/16	1.96"
15052A	9020.20.1/4	20mm	1/4	1.96"
15053A	9020.20.5/16	20mm	5/16	1.96"
15049A	9020.20.3/8	20mm	3/8	1.96"
15054A	9020.20.7/16	20mm	7/16	1.96"
15055A	9020.20.1/2	20mm	1/2	1.96"
15056A	9020.20.5/8	20mm	5/8	1.96"

20mm Reduction Sleeves (metric)

EDP	Part Number	D	d	L
15070A	9020.20.03	20mm	3mm	1.96"
15071A	9020.20.04	20mm	4mm	1.96"
15072A	9020.20.05	20mm	5mm	1.96"
15073A	9020.20.06	20mm	6mm	1.96"
15074A	9020.20.08	20mm	8mm	1.96"
15075A	9020.20.10	20mm	10mm	1.96"
15095A	9020.20.11	20mm	11mm	1.96"
15076A	9020.20.12	20mm	12mm	1.96"
15077A	9020.20.14	20mm	14mm	1.96"
15089A	9020.20.15	20mm	15mm	1.96"
15078A	9020.20.16	20mm	16mm	1.96"
15090A	9020.20.18	20mm	18mm	1.96"

1-1/4" Reduction Sleeves

EDP	Part Number	D	d	L
15300A	9020.1-1/4.1/4	1-1/4	1/4	2.48"
15301A	9020.1-1/4.5/16	1-1/4	5/16	2.48"
15302A	9020.1-1/4.3/8	1-1/4	3/8	2.48"
15303A	9020.1-1/4.1/2	1-1/4	1/2	2.48"
15304A	9020.1-1/4.5/8	1-1/4	5/8	2.48"
15305A	9020.1-1/4.3/4	1-1/4	3/4	2.48"
15306A	9020.1-1/4.7/8	1-1/4	7/8	2.48"
15307A	9020.1-1/4.1	1-1/4	1	2.48"

32mm Reduction Sleeves - (inch)

EDP	Part Number	D	d	L
15057A	9020.32.1/4	32mm	1/4	2.48"
15058A	9020.32.5/16	32mm	5/16	2.48"
15065A	9020.32.3/8	32mm	3/8	2.48"
15059A	9020.32.7/16	32mm	7/16	2.48"
15060A	9020.32.1/2	32mm	1/2	2.48"
15061A	9020.32.5/8	32mm	5/8	2.48"
15062A	9020.32.3/4	32mm	3/4	2.48"
15063A	9020.32.7/8	32mm	7/8	2.48"
15064A	9020.32.1	32mm	1	2.48"

32mm Reduction Sleeves - (metric)

EDP	Part Number	D	d	L
15079A	9020.32.06	32mm	6mm	2.48"
15080A	9020.32.08	32mm	8mm	2.48"
15081A	9020.32.10	32mm	10mm	2.48"
15082A	9020.32.12	32mm	12mm	2.48"
15083A	9020.32.14	32mm	14mm	2.48"
15084A	9020.32.16	32mm	16mm	2.48"
15085A	9020.32.18	32mm	18mm	2.48"
15086A	9020.32.20	32mm	20mm	2.48"
15092A	9020.32.22	32mm	22mm	2.48"
15087A	9020.32.24	32mm	24mm	2.48"
15088A	9020.32.25	32mm	25mm	2.48"

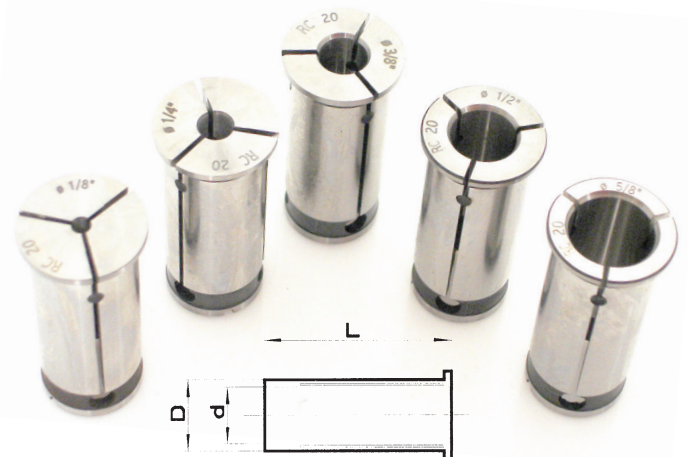

ER COLLET CHUCKS



CAT 40 & 50 Stub, Standard & Long

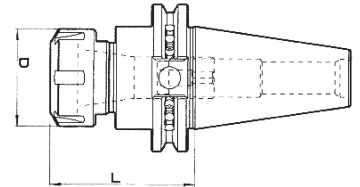

ER11 CAT Shank

EDP	Part Number	Shank	Collet Range	D	L
51010C	1196.11.40CATN	CAT40	.019-.276	0.75	2.50
51011C	2196.11.40CATN	CAT40	.019-.276	0.75	4.00
51012C	3196.11.40CATN	CAT40	.019-.276	0.75	6.00

ER16 CAT Shank

EDP	Part Number	Shank	Collet Range	D	L
51013C	1196.16.40CATN	CAT40	.019-.394	1.26	2.50
11006C	2196.16.40CATN	CAT40	.019-.394	1.26	3.00
11007C	4196.16.40CATN	CAT40	.019-.394	1.26	6.00
11025C	1196.16.50CATN	CAT50	.019-.394	1.26	4.00
11026C	2196.16.50CATN	CAT50	.019-.394	1.26	5.00
11027C	3196.16.50CATN	CAT50	.019-.394	1.26	6.00

ER20 CAT Shank

EDP	Part Number	Shank	Collet Range	D	L
17391C	1196.20.40CATN	CAT40	.039-.512	1.38	2.50
51014C	2196.20.40CATN	CAT40	.039-.512	1.38	4.00
51015C	3196.20.40CATN	CAT40	.039-.512	1.38	6.00
51020C	1196.20.50CATN	CAT50	.039-.512	1.38	4.00
51021C	2196.20.50CATN	CAT50	.039-.512	1.38	6.00

ER25 CAT Shank

EDP	Part Number	Shank	Collet Range	D	L
11008C	1196.25.40CATN	CAT40	.118-.630	1.65	2.50
11009C	2196.25.40CATN	CAT40	.118-.630	1.65	4.00
51016C	3196.25.40CATN	CAT40	.118-.630	1.65	8.00
11028C	1196.25.50CATN	CAT50	.118-.630	1.65	2.50
11030C	2196.25.50CATN	CAT50	.118-.630	1.65	4.00
51022C	3196.25.50CATN	CAT50	.118-.630	1.65	6.00

ER32 CAT Shank

EDP	Part Number	Shank	Collet Range	D	L
11012C	1196.32.40CATN	CAT40	.079-.787	1.97	3.00
11013C	2196.32.40CATN	CAT40	.079-.787	1.97	5.00
51017C	3196.32.40CATN	CAT40	.079-.787	1.97	8.00
11031C	1196.32.50CATN	CAT50	.079-.787	1.97	4.00
51023C	2196.32.50CATN	CAT50	.079-.787	1.97	6.00
51024C	3196.32.50CATN	CAT50	.079-.787	1.97	8.00

ER40 CAT Shank

EDP	Part Number	Shank	Collet Range	D	L
51018C	1196.40.40CATN	CAT40	.079-1.024	2.48	3.50
51019C	2196.40.40CATN	CAT40	.079-1.024	2.48	6.00
51025C	1196.40.50CATN	CAT50	.079-1.024	2.48	4.00
51026C	2196.40.50CATN	CAT50	.079-1.024	2.48	6.00

BT30 Shank

EDP	Part Number	Collet Size	Collet Range	D	L
11211C	1196.16.30BT N	ER16	.019-.394	1.260	2.165
11212C	1196.25.30BT N	ER25	.039-.630	1.654	2.165
11213C	1196.32.30BT N	ER32	.079-.787	1.969	2.362

BT40 Shank

EDP	Part Number	Collet Size	Collet Range	D	L
11254C	1196.25.40BT N	ER25	.039-.631	1.654	2.756
11255C	1196.32.40BT N	ER32	.079-.787	1.969	2.756
11256C	2196.32.40BT N	ER32	.079-.787	1.969	3.937

BT50 Shank

EDP	Part Number	Collet Size	Collet Range	D	L
11257C	1196.32.50BT N	ER32	.079-.787	1.969	3.150
11258C	2196.32.50BT N	ER32	.079-.787	1.969	3.937
11259C	1196.40.50BT N	ER40	.079-1.024	2.480	3.150



Straight Shank ER Collet Chucks

EDP	Part Number	Collet Size	Collet Range	D1	L1	L2	D2
51068A	2217.11.5/8	ER11	.019-.276	0.625	6.480	0.77	0.63
51069A	2217.16.3/4	ER16	.019-.394	0.750	5.730	1.00	0.87
51070A	2217.20.1	ER20	.039-.512	1.000	5.560	1.18	1.10
50171A	2217.25.1	ER25	.039-.630	1.000	2.500	1.30	1.38
50198A	2197.32.1N	ER32	.079-.787	1.000	2.140	2.08	1.96
50199A	2197.40.1N	ER40	.079-1.024	1.000	2.000	2.30	2.50



Straight Shank Nuts

EDP	Part Number	Collet Size	Nut
60002A	9131.11.16	ER11	Mini
60003A	9131.16.22	ER16	Mini
60004A	9131.20.28	ER20	Mini
60005A	9131.25.35	ER25	Mini
14963A	9131.32.50	ER32	Std
14964A	9131.40.63	ER40	Std

VDI Collet Chuck Type E4 (Static)

EDP	Part Number	Collet Size	Collet Range	d1	d6	d10	b	b1	h
14204B	88E4.16.20ER	ER20	.039-.512	0.629	1.575	1.378	1.772	0.551	0.709
14205B	88E4.20.25ER	ER25	.039-.630	0.787	1.969	1.654	2.165	0.709	-
14207B	88E4.30.25ER	ER25	.039-.630	1.181	2.677	1.654	2.165	0.866	1.102
14210B	88.12.40.25ER	ER25	.039-.630	1.575	3.268	1.654	2.717	0.866	1.280
14206B	88E4.20.32ER	ER32	.079-.787	0.787	1.969	1.969	2.165	0.709	-
14208B	88.12.30.32ER	ER32	.079-.787	1.181	2.677	1.969	2.165	0.866	1.102
14211B	88E4.40.32ER	ER32	.079-.787	1.575	3.268	1.969	3.307	0.866	1.280
14213B	88.12.50.32ER	ER32	.079-.787	1.969	3.858	1.969	3.307	1.181	1.378
14209B	88E4.30.40ER	ER40	.079-1.024	1.181	2.677	2.48	2.953	1.024	1.102
14212B	88E4.40.40ER	ER40	.079-1.024	1.575	3.268	2.48	2.953	0.866	1.280
14014B	88E4.50.40ER	ER40	.079-1.024	1.969	3.858	2.48	3.465	1.181	1.378
14015B	88E4.60.40ER	ER40	.079-1.024	2.362	4.843	2.48	3.543	1.181	1.673

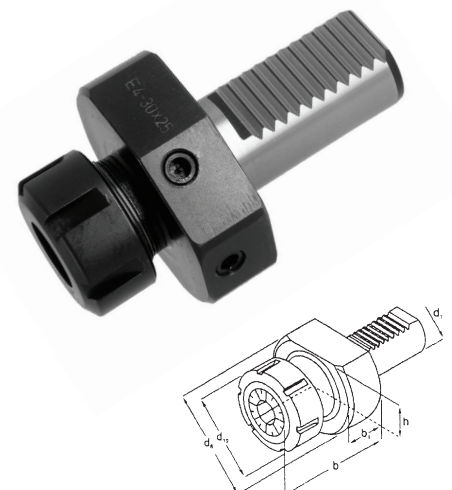

ER COLLET CHUCKS



HSK 32, HSK 40 & HSK 50

What are the advantages OF THE HSK Tool Clamping System?

An international industry standard which results in more competitive prices with many suppliers to choose from.

Stiffer and more rigid connection between the tool and spindle.

Higher spindle speeds are possible because the taper is gripped from the inside.

Higher speeds actually increase clamping force.

Excellent repeatability and accuracy.

Improved rigidity for long tools.

Tools rest in clamped position on the flange.

Faster tool change is possible because of the short tool taper.

Tool clamping stresses are confined to the front of the spindle.

Coolant Flow Adapters

Coolant Flow Adapters for HSK Holders

EDP	Part Number	Shank	d (mm)	Thread Mount
14975A	94614012	HSK-40A	8	M12X1
14976A	94615016	HSK-50A	10	M16X1
14977A	94616318	HSK-63A	12	M18X1
14978A	94618020	HSK-80A	14	M20X1.5
14979A	946110024	HSK-100A	16	M24X1.5

EDP	Wrench	HSK
14944A	9427.08.13	40
14945A	9427.10.15	50
14946A	9427.12.16	63
14947A	9427.14.24	80
14948A	9427.16.26	100

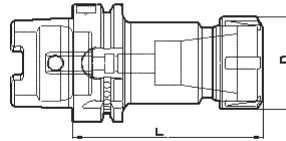

HSK 32 Form A+C

EDP	Part Number	Taper	Collet Size	Collet Range	D	L
51027B	1218.16.H32A	32A	ER16	.019-.394	0.870	3.150

HSK 40 Form A+C

EDP	Part Number	Taper	Collet Size	Collet Range	D	L
51028B	1218.16.H40A	40A	ER16	.019-.394	0.870	3.150
51029B	2218.16.H40A	40A	ER16	.019-.630	0.870	4.720
51030B	1198.25.H40AN	40A	ER25	.039-.394	1.650	3.150
51031B	2198.25.H40AN	40A	ER25	.039-.630	1.650	4.720
51032B	1198.32.H40AN	40A	ER32	.079-.787	1.970	3.940

HSK 40 Form E

EDP	Part Number	Taper	Collet Size	Collet Range	D	L
51041B	1218.16.H40E	40E	ER16	.019-.394	0.870	3.150
51042B	2218.16.H40E	40E	ER16	.019-.394	0.870	4.720
51043B	1198.25.H40EN	40E	ER25	.039-.630	1.650	3.150
51044B	2198.25.H40EN	40E	ER25	.039-.630	1.650	4.720
51045B	1198.32.H40EN	40E	ER32	.079-.787	1.970	3.940

HSK 50 Form A+C

EDP	Part Number	Taper	Collet Size	Collet Range	D	L
51033B	1218.16.H50A	50A	ER16	.019-.394	0.866	3.937
51034B	1198.25.H50AN	50A	ER25	.039-.630	1.654	3.937
51035B	1198.32.H50AN	50A	ER32	.079-.787	1.969	3.937

HSK 50 Form E

EDP	Part Number	Taper	Collet Size	Collet Range	D	L
51046B	1218.16.H50E	50E	ER16	.019-.394	0.866	3.937
51047B	1198.25.H50EN	50E	ER25	.039-.630	1.654	3.937
51048B	1198.32.H50EN	50E	ER32	.079-.787	1.969	3.937

HSK 50 Form F

EDP	Part Number	Taper	Collet Size	Collet Range	D	L
51057B	1218.16.H50F	50F	ER16	.019-.394	0.866	3.150
51058B	1198.25.H50FN	50F	ER25	.039-.630	1.654	3.150
51059B	1198.32.H50FN	50F	ER32	.079-.787	1.969	3.937

HSK 63 & HSK 100



HSK 63 Form A+C

EDP	Part Number	Taper	Collet Size	Collet Range	D	L
11413B	1218.16.H63A	63A	ER16	.019-.394	0.866	3.937
11414B	1198.25.H63AN	63A	ER25	.039-.630	1.654	3.937
11415B	1198.32.H63AN	63A	ER32	.079-.787	1.969	3.937
11416B	1198.40.H63AN	63A	ER40	.079-1.024	2.480	4.724

HSK 63 Form E

EDP	Part Number	Taper	Collet Size	Collet Range	D	L
51049B	1218.16.H63E	63E	ER16	.019-.394	0.866	6.300
51051B	1198.25.H63EN	63E	ER25	.039-.630	1.654	3.937
51053B	1198.32.H63EN	63E	ER32	.079-.787	1.969	3.937
51055B	1198.40.H63EN	63E	ER40	.079-1.024	2.480	4.724
51050B	2218.16.H63E	63E	ER16	.019-.394	0.866	6.300
51052B	2198.25.H63EN	63E	ER25	.039-.630	1.654	6.300
51054B	2198.32.H63EN	63E	ER32	.079-.787	1.969	6.300
51056B	2198.40.H63EN	63E	ER40	.079-1.024	2.480	6.300

HSK 63 Form F

EDP	Part Number	Taper	Collet Size	Collet Range	D	L
51060B	1218.16.H63F	63F	ER16	.019-.394	0.866	3.937
51062B	1198.25.H63FN	63F	ER25	.039-.630	1.654	3.937
51064B	1198.32.H63FN	63F	ER32	.079-.787	1.969	3.937
51066B	1198.40.H63FN	63F	ER40	.079-1.024	2.480	4.724
51061B	2218.16.H63F	63F	ER16	.019-.394	0.866	6.300
51065B	2198.32.H63FN	63F	ER32	.079-.787	1.969	6.300

HSK 100 Form A+C

EDP	Part Number	Taper	Collet Size	Collet Range	D	L
51036B	1218.16.H100A	100A	ER16	.019-.394	0.866	6.300
51037B	1198.32.H100AN	100A	ER32	.079-.787	1.969	3.937
51039B	1198.40.H100AN	100A	ER40	.079-1.024	2.480	4.724
51038B	2198.32.H100AN	100A	ER32	.079-.787	1.969	6.300
51040B	2198.40.H100AN	100A	ER40	.079-1.024	2.480	6.300

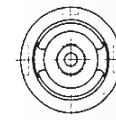
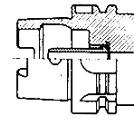

HSK Form A

Automatic Tool Change
Most Common HSK Form.

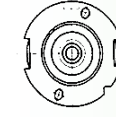
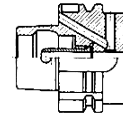

HSK Form B

Automatic Tool Change,
Larger flange diameter
for a maximum
spindle interface.

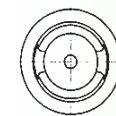
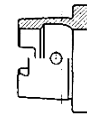

HSK Form C

Manual Tool Change,
Front Clamping For use
with tool extensions
and short spindles
on transfer lines

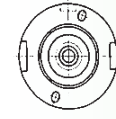
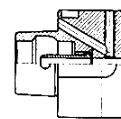

HSK Form D

Manual Tool Change
Larger flange diameter
for maximum
spindle interface.

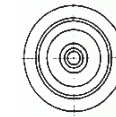
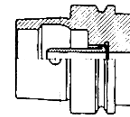

HSK Form E

Automatic tool Change
No driveway, common in
wood-working machines,
easy to balance.
Used For: High Speed Machining.

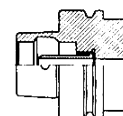

HSK Form F

Automatic tool Change
Larger flange diameter for
a maximum spindle
interface, no drive keyway.
Used For: High Speed Machining

ER COLLETS

ER11, ER16 & ER20

Standard & Coolant Tight - Individual & Sets



DIN 6499 European



ER11			ER16					ER20				
Standard			Standard		Coolant Tight			Standard			Coolant Tight	
Clamping Range	EDP	Part Number	Clamping Range	EDP	Part Number	EDP	Part Number	Clamping Range	EDP	Part Number	EDP	Part Number
.019-.039	50172A	9010.11.01	.019-.039	50182A	9010.16.01							
.039-.059	50173A	9010.11.015	.039-.079	13799A	9010.16.02			.039-.079	13785A	9010.20.02		
.059-.079	50174A	9010.11.02	.079-.118	13800A	9010.16.03	13871A	9010.16.03TR	.079-.118	13786A	9010.20.03	13966A	9010.20.03TR
.079-.098	13400A	9010.11.025	.118-.157	13801A	9010.16.04	13872A	9010.16.04TR	.118-.157	13787A	9010.20.04	13967A	9010.20.04TR
.098-.118	50175A	9010.11.03	.157-.197	13802A	9010.16.05	13873A	9010.16.05TR	.157-.197	13788A	9010.20.05	13968A	9010.20.05TR
.118-.138	50176A	9010.11.035	.197-.236	13803A	9010.16.06	13874A	9010.16.06TR	.197-.236	13789A	9010.20.06	13969A	9010.20.06TR
.138-.157	13403A	9010.11.04	.236-.276	13804A	9010.16.07	13875A	9010.16.07TR	.236-.276	13790A	9010.20.07	13970A	9010.20.07TR
.157-.177	50177A	9010.11.045	.276-.315	13805A	9010.16.08	13876A	9010.16.08TR	.276-.315	13791A	9010.20.08	13971A	9010.20.08TR
.177-.197	50178A	9010.11.05	.315-.354	13806A	9010.16.09	13877A	9010.16.09TR	.315-.354	13792A	9010.20.09	13972A	9010.20.09TR
.197-.217	50179A	9010.11.055	.354-.394	13807A	9010.16.10	13878A	9010.16.10TR	.354-.394	13793A	9010.20.10	13973A	9010.20.10TR
.217-.236	13407A	9010.11.06						.394-.433	13794A	9010.20.11	13974A	9010.20.11TR
.236-.256	50780A	9010.11.065						.433-.472	13795A	9010.20.12	13975A	9010.20.12TR
.256-.276	50181A	9010.11.07						.472-.512	13796A	9010.20.13	13976A	9010.20.13TR

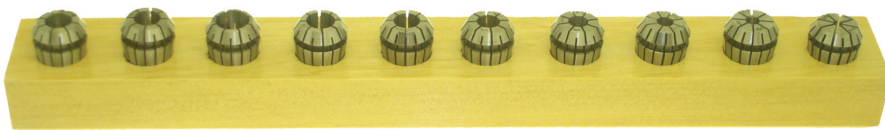

ER Collet Sets



ER Collet Chuck Wrenches

EDP	Part Number	Size
50196A	M-4917-00	ER11
14970A	M-4732-00	ER16
14971A	M-4735-00	ER20
14972A	M-4742-00	ER25
14973A	M-4750-00	ER32
14974A	M-4763-00	ER40

ER Collet Chuck Mini Nut Wrenches

EDP	Part Number	Size
14989A	M-4716-00	ER11
14990A	M-4722-00	ER16
14991A	M-4728-00	ER20
14992A	M-4735-01	ER25

Standard				Coolant Tight			
EDP	Part Number	QTY	Clamping Range	EDP	Part Number	QTY	Clamping Range
13896A	9010.16.00	8	.079-.394	50192A	9010.16.00TR	8	.079-.394
50188A	9010.20.00	12	.039-.512	50193A	9010.20.00TR	11	.079-.512
50189A	9010.25.00	15	.039-.630	60001A	9010.25.00TR	15	.079-.630
13894A	9010.32.00	18	.079-.787	50194A	9010.32.00TR	18	.079-.787
50191A	9010.40.00	24	.079-1.024	50195A	9010.40.00TR	23	.118-1.024

Quality • High Accuracy



ER25					ER32					ER40				
Standard			Coolant Tight		Standard			Coolant Tight		Standard			Coolant Tight	
Clamping Range	EDP	Part Number	EDP	Part Number	Clamping Range	EDP	Part Number	EDP	Part Number	Clamping Range	EDP	Part Number	EDP	Part Number
.039-.079	50184A	9010.25.02								.079-.118			13940A	9010.40.03TR
.079-.118	13899A	9010.25.03	13901A	9010.25.03TR	.079-.118	13819A	9010.32.03	13921A	9010.32.03TR	.079-.118	13837A	9010.40.03		
.118-.157	13898A	9010.25.04	13902A	9010.25.04TR	.118-.157	13820A	9010.32.04	13922A	9010.32.04TR	.118-.157	13838A	9010.40.04	13941A	9010.40.04TR
.157-.197	13897A	9010.25.05	13903A	9010.25.05TR	.157-.197	13821A	9010.32.05	13923A	9010.32.05TR	.157-.197	13839A	9010.40.05	13942A	9010.40.05TR
.197-.236	13808A	9010.25.06	13904A	9010.25.06TR	.197-.236	13822A	9010.32.06	13924A	9010.32.06TR	.197-.236	13840A	9010.40.06	13943A	9010.40.06TR
.236-.276	13809A	9010.25.07	13905A	9010.25.07TR	.236-.276	13823A	9010.32.07	13925A	9010.32.07TR	.236-.276	13841A	9010.40.07	13944A	9010.40.07TR
.276-.315	13810A	9010.25.08	13906A	9010.25.08TR	.276-.315	13824A	9010.32.08	13926A	9010.32.08TR	.276-.315	13842A	9010.40.08	13945A	9010.40.08TR
.315-.354	13811A	9010.25.09	13907A	9010.25.09TR	.315-.354	13825A	9010.32.09	13927A	9010.32.09TR	.315-.354	13843A	9010.40.09	13946A	9010.40.09TR
.354-.394	13812A	9010.25.10	13908A	9010.25.10TR	.354-.394	13826A	9010.32.10	13928A	9010.32.10TR	.354-.394	13844A	9010.40.10	13947A	9010.40.10TR
.394-.433	13813A	9010.25.11	13909A	9010.25.11TR	.394-.433	13827A	9010.32.11	13929A	9010.32.11TR	.394-.433	13845A	9010.40.11	13948A	9010.40.11TR
.433-.472	13814A	9010.25.12	13910A	9010.25.12TR	.433-.472	13828A	9010.32.12	13930A	9010.32.12TR	.433-.472	13846A	9010.40.12	13949A	9010.40.12TR
.472-.512	13815A	9010.25.13	13911A	9010.25.13TR	.472-.512	13829A	9010.32.13	13931A	9010.32.13TR	.472-.512	13847A	9010.40.13	13950A	9010.40.13TR
.512-.551	13816A	9010.25.14	13912A	9010.25.14TR	.512-.551	13830A	9010.32.14	13932A	9010.32.14TR	.512-.551	13848A	9010.40.14	13951A	9010.40.14TR
.551-.591	13817A	9010.25.15	13913A	9010.25.15TR	.551-.591	13831A	9010.32.15	13933A	9010.32.15TR	.551-.591	13849A	9010.40.15	13952A	9010.40.15TR
.591-.630	13818A	9010.25.16	13914A	9010.25.16TR	.591-.630	13832A	9010.32.16	13934A	9010.32.16TR	.591-.630	13850A	9010.40.16	13953A	9010.40.16TR
					.630-.669	13833A	9010.32.17	13935A	9010.32.17TR	.630-.669	13851A	9010.40.17	13954A	9010.40.17TR
					.669-.709	13834A	9010.32.18	13936A	9010.32.18TR	.669-.709	13852A	9010.40.18	13955A	9010.40.18TR
					.709-.748	13835A	9010.32.19	13937A	9010.32.19TR	.709-.748	13853A	9010.40.19	13956A	9010.40.19TR
					.748-.787	13836A	9010.32.20	13938A	9010.32.20TR	.748-.787	13854A	9010.40.20	13957A	9010.40.20TR
										.787-.827	13855A	9010.40.21	13958A	9010.40.21TR
										.827-.866	13856A	9010.40.22	13959A	9010.40.22TR
										.866-.906	13857A	9010.40.23	13960A	9010.40.23TR
										.906-.945	13858A	9010.40.24	13961A	9010.40.24TR
										.945-.984	13859A	9010.40.25	13962A	9010.40.25TR
										.984-1.024	13860A	9010.40.26	13963A	9010.40.26TR



ER Collet Chuck Nuts			ER Collet Chuck Nuts with Ball Bearings			ER Collet Chuck Mini Nuts			Hex Nuts		
EDP	Part Number	Collet	EDP	Part Number	Collet	EDP	Part Number	Collet	EDP	Part Number	Size
14960A	9130.16.32	ER16	14966A	9120.20.35	ER20	60002A	9131.11.16	ER11	60021A	9133.11.19	ER11
14961A	9130.20.35	ER20	14967A	9120.25.42	ER25	60003A	9131.16.22	ER16	60022A	9133.16.28	ER16
14962A	9130.25.42	ER25	14968A	9120.32.50	ER32	60004A	9131.20.28	ER20			
14963A	9130.32.50	ER32	14969A	9120.40.63	ER40	60005A	9131.25.35	ER25			
14964A	9130.40.63	ER40									



DA COLLETS & HOLDERS

DA100, DA180, DA200 & DA300



DA Collet Dimensions	DA 100	DA 180	DA 200	DA 300
D =	.769"	1.035"	.532"	.375"
L =	1.44"	1.64"	1.19"	1.004"
Bore Range	1/8-9/16	1/8-3/4	1/16-3/8	1/16-1/4
Collapse	1/64"	1/64"	1/64"	1/64"
Accuracy	.0005" T.I.R. (at nose)			

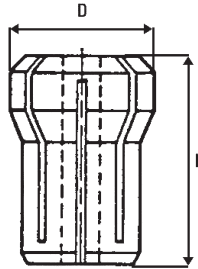

Double Angle Straight Shank Collet Holder

EDP	Part Number	Shank Dia	DA Collet	OAL
X50200B	4119.050.DA300	0.50	300	6.88
X50201B	4119.075.DA200	0.75	200	7.23
X50202B	4119.1000.DA100	1.00	100	7.50
X50203B	4119.1250.DA180	1.25	180	7.41

Double Angle Collet Sets

EDP	Collet Series	Description	Part Number
X60020A	DA300	9 Pieces (1/8"-1/4") by 64ths	DA300-SET9
X60021A	DA200	17 Pieces (1/8"-3/8") by 64ths	DA200-SET17
X60022A	DA100	29 Pieces (1/8"-9/16") by 64ths	DA100-SET29
X60023A	DA180	33 Pieces (1/4"-3/4") by 64ths	DA180-SET33

ID Hole Size		300 DA	200 DA	100 DA	180 DA
Size	Dec.	EDP	EDP	EDP	EDP
3/64"	0.047	X13981A	X13995A	X14018A	X14052A
1/16"	0.063	X13982A	X13996A	X14019A	X14053A
5/64"	0.078	X13983A	X13997A	X14020A	X14054A
3/32"	0.094	X13984A	X13998A	X14021A	X14055A
7/64"	0.109	X13985A	X13999A	X14022A	X14056A
1/8"	0.125	X13986A	X14000A	X14023A	X14057A
9/64"	0.141	X13987A	X14001A	X14024A	X14058A
5/32"	0.156	X13988A	X14002A	X14025A	X14059A
11/64"	0.172	X13989A	X14003A	X14026A	X14060A
3/16"	0.188	X13990A	X14004A	X14027A	X14061A
13/64"	0.203	X13991A	X14005A	X14028A	X14062A
7/32"	0.219	X13992A	X14006A	X14029A	X14063A
15/64"	0.234	X13993A	X14007A	X14030A	X14064A
1/4"	0.250	X13994A	X14008A	X14031A	X14065A
17/64"	0.266		X14009A	X14032A	X14066A
9/32"	0.281		X14010A	X14033A	X14067A
19/64"	0.297		X14011A	X14034A	X14068A
5/16"	0.313		X14012A	X14035A	X14069A
21/64"	0.328		X14013A	X14036A	X14070A
11/32"	0.349		X14014A	X14037A	X14071A
23/64"	0.359		X14015A	X14038A	X14072A
3/8"	0.375		X14016A	X14039A	X14073A
25/64	0.391		X14017A	X14040A	X14074A
13/32"	0.406			X14041A	X14075A
27/64	0.422			X14042A	X14076A
7/16"	0.438			X14043A	X14077A
29/64"	0.453			X14044A	X14078A
15/32"	0.469			X14045A	X14079A
31/64"	0.484			X14046A	X14080A
1/2"	0.500			X14047A	X14081A
33/64"	0.516			X14048A	X14082A
17/32"	0.531			X14049A	X14083A
35/64"	0.547			X14050A	X14084A
9/16"	0.563			X14051A	X14085A
37/64"	0.578				X14086A
19/32"	0.594				X14087A
39/64"	0.609				X14088A
5/8"	0.625				X14089A
41/64"	0.641				X14090A
21/32"	0.656				X14091A
43/64	0.672				X14092A
11/16"	0.688				X14093A
45/64"	0.703				X14094A
23/32"	0.719				X14095A
47/64"	0.734				X14096A
3/4"	0.750				X14097A

BT & HSK Metric Standards

METRIC STANDARDS

HSK 63 Form A+C Standard Length

EDP	Part Number	Shank	d Metric	d Decimal	D	L
11426B	1248.06.H63A	HSK63A	6mm	0.236	25	65
11427B	1248.08.H63A	HSK63A	8mm	0.315	28	65
11428B	1248.10.H63A	HSK63A	10mm	0.394	35	65
11429B	1248.12.H63A	HSK63A	12mm	0.472	42	80
11484B	1248.14.H63A	HSK63A	14mm	0.551	44	80
11430B	1248.16.H63A	HSK63A	16mm	0.630	48	80
11485B	1248.18.H63A	HSK63A	18mm	0.709	50	80
11431B	1248.20.H63A	HSK63A	20mm	0.787	52	80
11432B	1248.25.H63A	HSK63A	25mm	0.984	64	110
11433B	1248.32.H63A	HSK63A	32mm	1.260	64	110

HSK 63 Form A+C Long Length

EDP	Part Number	Shank	d Metric	d Decimal	D	L
11434B	2248.06.H63A	HSK63A	6mm	0.236	25	100
11435B	2248.08.H63A	HSK63A	8mm	0.315	28	100
11436B	2248.10.H63A	HSK63A	10mm	0.394	35	100
11437B	2248.12.H63A	HSK63A	12mm	0.472	42	120
11486B	2248.14.H63A	HSK63A	14mm	0.551	44	120
11438B	2248.16.H63A	HSK63A	16mm	0.630	48	120
11487B	2248.18.H63A	HSK63A	18mm	0.709	50	120
11439B	2248.20.H63A	HSK63A	20mm	0.787	52	120
11440B	2248.25.H63A	HSK63A	25mm	0.984	64	150
11441B	2248.32.H63A	HSK63A	32mm	1.260	72	150

HSK 100 Form A+C Standard Length

EDP	Part Number	Shank	d Metric	d Decimal	D	L
11511B	1248.06.H100A	HSK100A	6mm	0.236	25	80
11512B	1248.08.H100A	HSK100A	8mm	0.315	28	80
11513B	1248.10.H100A	HSK100A	10mm	0.394	35	80
11514B	1248.12.H100A	HSK100A	12mm	0.472	42	80
11572B	1248.14.H100A	HSK100A	14mm	0.551	44	80
11515B	1248.16.H100A	HSK100A	16mm	0.630	48	100
11573B	1248.18.H100A	HSK100A	18mm	0.709	48	100
11516B	1248.20.H100A	HSK100A	20mm	0.787	52	100
11517B	1248.25.H100A	HSK100A	25mm	0.984	64	100
11518B	1248.32.H100A	HSK100A	32mm	1.260	72	100

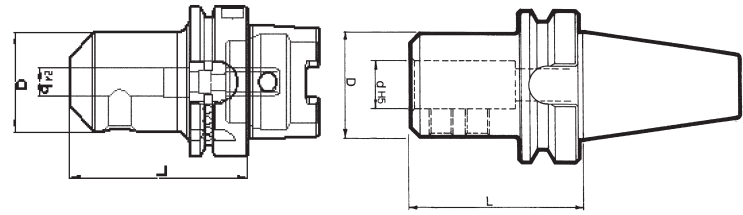

BT30 Standard Length

EDP	Part Number	Shank	d Metric	d Decimal	D	L
11220B	1246.06.30BT	BT30	6mm	0.236	25	50
11221B	1246.08.30BT	BT30	8mm	0.315	28	50
11222B	1246.10.30BT	BT30	10mm	0.394	35	50
11223B	1246.12.30BT	BT30	12mm	0.472	42	55
11224B	1246.16.30BT	BT30	16mm	0.630	48	63
11225B	1246.20.30BT	BT30	20mm	0.787	52	70

BT40 Standard Length

EDP	Part Number	Shank	d Metric	d Decimal	D	L
11226B	1246.06.40BT	BT40	6mm	0.236	25	50
11227B	1246.08.40BT	BT40	8mm	0.315	28	50
11228B	1246.10.40BT	BT40	10mm	0.394	35	63
11229B	1246.12.40BT	BT40	12mm	0.472	42	63
11230B	1246.16.40BT	BT40	16mm	0.630	48	63
11231B	1246.20.40BT	BT40	20mm	0.787	52	63
11232B	1246.25.40BT	BT40	25mm	0.984	65	90
11233B	1246.32.40BT	BT40	32mm	1.260	72	100

BT50 Standard Length

EDP	Part Number	Shank	d Metric	d Decimal	D	L
11234B	1246.06.50BT	BT50	6mm	0.236	25	63
11235B	1246.08.50BT	BT50	8mm	0.315	28	63
11236B	1246.10.50BT	BT50	10mm	0.394	35	70
11237B	1246.12.50BT	BT50	12mm	0.472	42	80
11238B	1246.16.50BT	BT50	16mm	0.630	48	80
11239B	1246.20.50BT	BT50	20mm	0.787	52	80
11240B	1246.25.50BT	BT50	25mm	0.984	65	100
11241B	1246.32.50BT	BT50	32mm	1.260	72	105
11242B	1246.40.50BT	BT50	40mm	1.575	80	120
11243B	1246.50.50BT	BT50	50mm	1.969	100	125

ENDMILL HOLDERS



CAT 40 Stub, Standard & Long

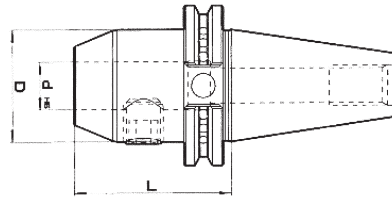

CAT40 Stub Length

EDP	Part Number	Bore Ø	Gage Length
11110C	0246.1/4.40CAT	1/4"	1.38
11112C	0246.5/16.40CAT	5/16"	1.38
11114C	0246.3/8.40CAT	3/8"	1.38
11118C	0246.1/2.40CAT	1/2"	1.75
11121C	0246.5/8.40CAT	5/8"	1.75
11124C	0246.3/4.40CAT	3/4"	1.75
11127C	0246.1.40CAT	1"	2.00
11129C	0246.1-1/4.40CAT	1 1/4"	2.00

CAT40 Standard Length

EDP	Part Number	Bore Ø	Gage Length
11060C	1246.1/4.40CAT	1/4"	2.50
11071C	1246.5/16.40CAT	5/16"	2.50
11061C	1246.3/8.40CAT	3/8"	2.50
11072C	1246.7/16.40CAT	7/16"	2.50
11062C	1246.1/2.40CAT	1/2"	2.50
11073C	1246.5/8.40CAT	5/8"	3.00
11063C	1246.3/4.40CAT	3/4"	3.00
11074C	1246.7/8.40CAT	7/8"	3.50
11075C	1246.1.40CAT	1"	4.00
11076C	1246.1-1/4.40CAT	1 1/4"	4.00
11077C	1246.1-1/2.40CAT	1 1/2"	4.70

CAT40 Long Length

EDP	Part Number	Bore Ø	Gage Length
11111C	2246.1/4.40CAT	1/4"	4.00
11113C	2246.5/16.40CAT	5/16"	4.00
11115C	2246.3/8.40CAT	3/8"	4.00
11117C	2246.7/16.40CAT	7/16"	4.00
11119C	2246.1/2.40CAT	1/2"	4.00
11122C	2246.5/8.40CAT	5/8"	4.00
11125C	2246.3/4.40CAT	3/4"	4.00
11128C	2246.1.40CAT	1"	6.00
11130C	2246.1-1/4.40CAT	1 1/4"	6.00



CAT 50 Stub, Standard & Long

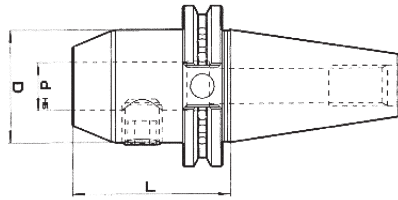

CAT50 Stub Length

EDP	Part Number	Bore Ø	Gage Length
11140C	0246.3/8.50CAT	3/8"	1.38
11148C	0246.1/2.50CAT	1/2"	1.75
11152C	0246.5/8.50CAT	5/8"	1.75
11156C	0246.3/4.50CAT	3/4"	1.75
11160C	0246.7/8.50CAT	7/8"	1.75
11163C	0246.1.50CAT	1"	2.00
11166C	0246.1-1/4.50CAT	1 1/4"	2.00
11170C	0246.1-1/2.50CAT	1 1/2"	2.25

CAT50 Standard Length

EDP	Part Number	Bore Ø	Gage Length
11133C	1246.1/4.50CAT	1/4"	2.50
11137C	1246.5/16.50CAT	5/16"	2.50
11064C	1246.3/8.50CAT	3/8"	2.50
11144C	1246.7/16.50CAT	7/16"	2.50
11065C	1246.1/2.50CAT	1/2"	2.63
11066C	1246.5/8.50CAT	5/8"	3.00
11067C	1246.3/4.50CAT	3/4"	3.00
11161C	1246.7/8.50CAT	7/8"	3.75
11068C	1246.1.50CAT	1"	4.00
11167C	1246.1-1/4.50CAT	1 1/4"	4.00
11171C	1246.1-1/2.50CAT	1 1/2"	4.50
11175C	1246.2.50CAT	2"	5.38

CAT50 Long Length

EDP	Part Number	Bore Ø	Gage Length
11134C	2246.1/4.50CAT	1/4"	4.00
11138C	2246.5/16.50CAT	5/16"	4.00
11141C	2246.3/8.50CAT	3/8"	4.00
11145C	2246.7/16.50CAT	7/16"	4.00
11149C	2246.1/2.50CAT	1/2"	4.00
11153C	2246.5/8.50CAT	5/8"	4.00
11157C	2246.3/4.50CAT	3/4"	4.00
11162C	2246.7/8.50CAT	7/8"	6.00
11164C	2246.1.50CAT	1"	6.00
11168C	2246.1-1/4.50CAT	1 1/4"	6.00
11172C	2246.1-1/2.50CAT	1 1/2"	7.00

Endmill Socket
T.I.R. $\leq .0002"$



Meets or Exceeds AT3 Taper

Traverse Ground Shank



SHELLMILL HOLDERS & JACOBS TAPER HOLDERS

CAT & BT Shanks

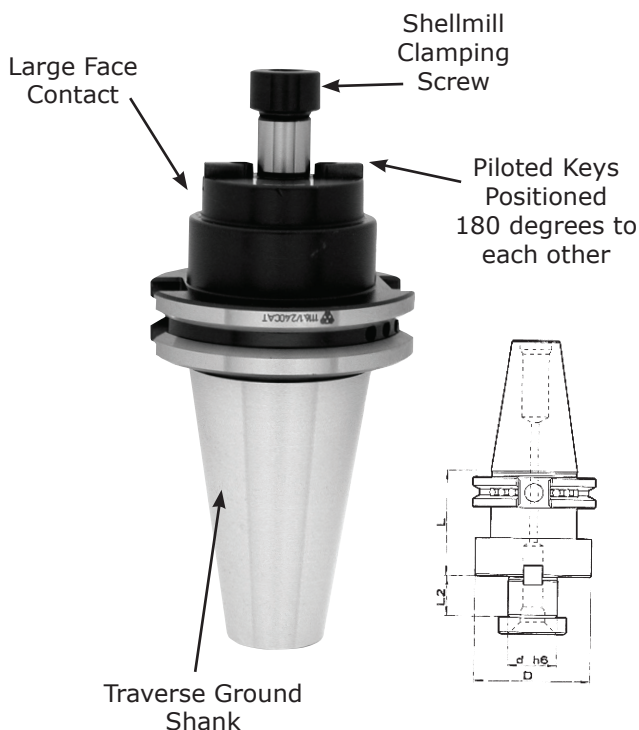

CAT40 Shellmill Holder

EDP	Part Number	d	D	L2	L
11000C	1116.1/2.40CAT	1/2	1.38	0.57	1.75
11078C	1116.3/4.40CAT	3/4	2.00	0.67	1.75
11079C	1116.1.40CAT	1	2.38	0.67	1.75
11080C	1116.1-1/4.40CAT	1 1/4	2.88	0.67	2.00
11004C	1116.1-1/2.40CAT	1 1/2	3.80	0.93	2.00

CAT50 Shellmill Holder

EDP	Part Number	d	D	L2	L
11081C	1116.3/4.50CAT	3/4	2.00	0.67	1.75
11082C	1116.1.50CAT	1	2.75	0.67	1.75
11083C	1116.1-1/4.50CAT	1 1/4	2.88	0.67	1.75
11084C	1116.1-1/2.50CAT	1 1/2	3.80	0.93	3.00
15109C	1116.2.50CAT	2	4.38	0.93	4.00

BT30 Shellmill Holders - METRIC Standard

EDP	Part Number	d	D	L2	L
11215C	1086.16.30BT	16	38	17	35
11216C	1086.22.30BT	22	48	19	40
11217C	1086.27.30BT	27	58	21	40

BT40 Shellmill Holders - METRIC Standard

EDP	Part Number	d	D	L2	L
11244C	1086.16.40BT	16	38	17	45
11245C	1086.22.40BT	22	48	19	45
11246C	1086.27.40BT	27	58	21	45
11247C	1086.32.40BT	32	78	24	50
11248C	1086.40.40BT	40	88	27	55

BT50 Shellmill Holders - METRIC Standard

EDP	Part Number	d	D	L2	L
11249C	1086.16.50BT	16	38	17	60
11250C	1086.22.50BT	22	48	19	60
11251C	1086.27.50BT	27	58	21	60
11252C	1086.32.50BT	32	78	24	60
11253C	1086.40.50BT	40	88	27	60

CAT40 Jacobs Taper Holder

EDP	Part Number	Jacobs Taper	B	L
11087C	1576.02.40CAT	#2 Taper	0.48	1.57
11088C	1576.33.40CAT	#33 Taper	0.62	1.57
11089C	1576.06.40CAT	#6 Taper	0.70	1.57

CAT50 Jacobs Taper Holder

EDP	Part Number	Jacobs Taper	B	L
11090C	1576.33.50CAT	#33 Taper	0.62	1.97
11091C	1576.06.50CAT	#6 Taper	0.70	1.97

